

REV.	DESCRIPTION	DATE	BY

CA2 SERIES

1/16" WIRE ROPE

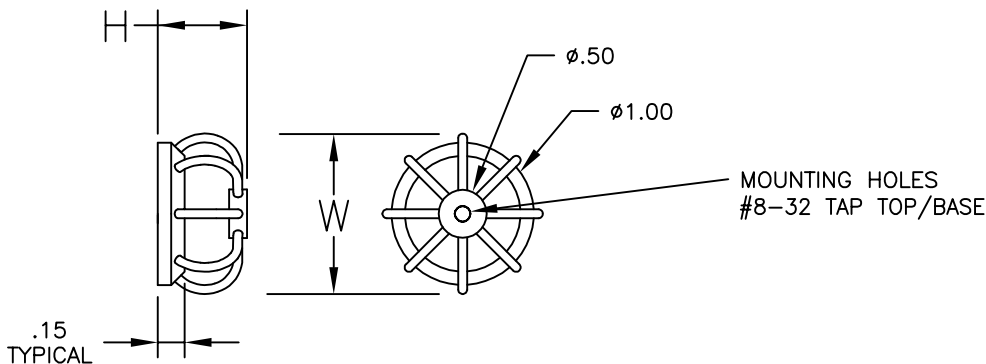

* CROSSED CABLE NOT PICTURED

ISOLATOR PART NO.	NOMINAL DIMENSIONS (in)		LOAD MODE	SHOCK AVERAGE K (lb/in)	VIBRATION AVERAGE K (lb/in)	MAX. RATED DYNAMIC TRAVEL (in)
	H \pm .03	W(REF)				
CA2-075-08-T2	.50	1.10	COMPRESSION	300	640	.12
			SHEAR	100	75	.14
			45 DEG. C/R	190	460	.20
CA2-100-08-T2	.65	1.30	COMPRESSION	110	235	.20
			SHEAR	40	40	.22
			45 DEG. C/R	65	180	.34
CA2-125-08-T2	.95	1.35	COMPRESSION	55	150	.28
			SHEAR	15	25	.30
			45 DEG. C/R	30	100	.48
CAX2-T2 (CROSSED CABLE)	.74	1.40	COMPRESSION	65	185	.24
			SHEAR	55	35	.22
			45 DEG. C/R	35	130	.40

OTHER MATERIALS, COMPOUNDS, OR FINISHES WITH EQUAL OR SUPERIOR PROPERTIES MAY BE SUBSTITUTED AS THEY BECOME AVAILABLE.

CERTIFIED FOR:

JOB NAME: _____
 CUSTOMER: _____
 CUSTOMER P.O.: _____
 SALES ORDER: _____

**MODEL CA2 SERIES
 CIRCULAR WIRE ROPE
 ISOLATOR**



THE VMC GROUP
The Power of Together
 Bloomingdale, NJ 07403
 Houston, TX 77041

SCALE:
 NONE

SHEET:



DRAWING NO.:

REVISION