

REV.	DESCRIPTION	DATE	BY
------	-------------	------	----

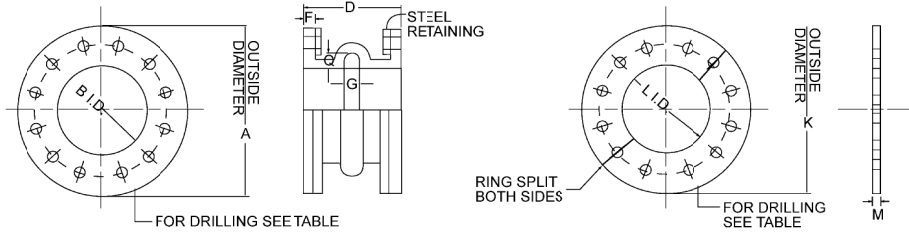

TYPICAL CONSTRUCTION

- 1) COATING OF HYPALON PAINT FOR EXTRA PROTECTION AGAINST OZONE AND WEATHER.
- 2) SPECIALLY COMPOUNDED OUTER COVER.
- 3) CARCASS MADE OF MULTIPLE PLIES OF TOUGH, RUBBER IMPREGNATED FABRIC.
- 4) FLANGES INTEGRAL WITH BODY WITH EXTRA PLIES FOR GREATER STRENGTH.
- 5) ARCH CONSTRUCTED TO GIVE CONTROLLED RESILIENCE.
- 6) EMBEDDED SOLID STEEL REINFORCED RINGS.
- 7) RUBBER FILLER BETWEEN RINGS.
- 8) SMOOTH, LEAK-PROOF TUBE OF NATURAL OR SYNTHETIC RUBBER.
- 9) GALVANIZED SPLIT FLANGE RETAINING RINGS.

TEMPERATURE

- 10) EXPANSION JOINTS CAN BE DESIGNED FOR A TEMPERATURE RANGE OF -20°F TO 400° F.

PRESSURE

- 11) EXPANSION JOINTS CAN BE DESIGNED FOR A WORKING PRESSURE UP TO 165 PSI ON STANDARD TYPES AND HIGHER ON SPECIAL TYPES. VACUUM RATES ARE UP TO 30 " DEPENDING ON TYPE.

TYPES

- 12) STANDARD SPOOL - SHORTEST FACE TO FACE AVAILABLE.
- 13) MULTIPLE ARCH - FOR INSTALLATION WHERE MOVEMENT EXCEED STANDARD TYPE.
- 14) FILLED ARCH - FOR INSTALLATIONS WHERE MATERIAL CARRIED MAY OBSTRUCT ARCH AND REDUCE FLEXIBILITY. ALLOWABLE MOVEMENT IS REDUCED 50%.
- 15) TAPER - CONCENTRIC OR ECCENTRIC FOR CONNECTING FLANGES OR DIFFERENT DIAMETERS.

INSTALLATION NOTE

- 16) ANCHOR PIPING AT BOTH ENDS OF EXPANSION JOINT. CONTROL UNITS MUST BE USED IF PIPING IS NOT ANCHORED.

ORDERING AND PRICING REQUIREMENTS:

PIPE SIZE
 PRESSURE OR VACUUM
 TEMPERATURE RANGE
 MOVEMENT- AXIAL OR LATERAL
 MATERIALS CARRIED
 EXTERNAL ENVIRONMENT

OTHER MATERIALS, COMPOUNDS OR FINISHES WITH EQUAL OR SUPERIOR PROPERTIES MAY BE SUBSTITUTED AS THEY BECOME AVAILABLE.

NOM. PIPE SIZE (IN.)	EXPANSION JOINT						RETAINING RING			DIA. OF BOLT CIRCLE	NO. OF BOLTS	DIA. OF BOLTS	DIA. DRILLED HOLES	EST. WT. (LB.)		WT. OF CNTRL UNIT SET	ALLOWABLE			RECOMMENDED WORKING PRESSURES (PSI)						VACUUM (IN. HG.)
	A	B	D	F	G	Q	K	L	M					EXP. JOINT	RET. RING		AXIAL COMPR.	AXIAL ELONG.	TRANS. DEFL.	TYPE						
																					A	B	C	D	E	
2	6	2	6	9/16	1/2	1-1/4	6	3-5/8	3/8	4-3/4	4	5/8	3/4	4	4	6-1/2	7/16	1/4	1/2	165	140	250	210	25	165	30
2-1/2	7	2-1/2	6	9/16	1/2	1-1/4	7	4-1/8	3/8	5-1/2	4	5/8	3/4	4-1/2	5-1/2	7-1/2	7/16	1/4	1/2	165	140	250	210	25	165	30
3	7	3	6	9/16	1/2	1-1/4	7-1/2	4-5/8	3/8	6	4	5/8	3/4	5-1/4	6	8	7/16	1/4	1/2	165	140	250	210	25	165	30
4	9	4	6	9/16	1/2	1-1/4	9	5-7/8	3/8	7-1/2	8	5/8	3/4	7	7-3/4	8	7/16	1/4	1/2	165	140	250	210	25	165	30
5	10	5	6	9/16	1/2	1-1/4	10	6-7/8	3/8	8-1/2	8	3/4	7/8	8-1/4	8-3/4	8	7/16	1/4	1/2	140	140	210	210	25	140	30
6	11	6	6	5/8	1/2	1-1/4	11	7-7/8	3/8	9-1/2	8	3/4	7/8	9-3/4	10	10	7/16	1/4	1/2	140	140	210	210	25	140	30
8	13-1/2	8	6	3/4	3/4	1-1/2	13-1/2	9-7/8	3/8	11-3/4	8	3/4	7/8	15	14	13	11/16	3/8	1/2	140	140	210	210	25	140	30
10	16	10	8	3/4	3/4	1-1/2	16	12-1/8	3/8	14-1/4	12	7/8	1	21	18	19	11/16	3/8	1/2	140	140	210	210	25	140	30
12	19	12	8	3/4	3/4	1-1/2	19	14-1/2	3/8	17	12	7/8	1	28	25	20	11/16	3/8	1/2	140	140	210	210	25	140	30
14	21	14	8	7/8	3/4	2	21	16-1/2	3/8	18-3/4	12	1	1-1/8	39	28	27	11/16	3/8	1/2	85	65	130	210	25	85	30
16	23-1/2	16	8	7/8	3/4	2	23-1/2	18-1/2	3/8	21-1/4	16	1	1-1/8	45-1/2	35	27	11/16	3/8	1/2	65	50	100	100	25	65	30
18	25	18	8	7/8	3/4	2	25	20-1/2	3/8	22-3/4	16	1-1/8	1-1/4	50-1/2	38	29	11/16	3/8	1/2	65	50	100	75	25	65	30
20	27-1/2	20	8	1	7/8	2	27-1/2	22-5/8	3/8	25	20	1-1/8	1-1/4	61	41	29	13/16	7/16	1/2	65	50	100	75	25	65	30
24	32	24	10	1	7/8	2	32	26-5/8	3/8	29-1/2	20	1-1/4	1-3/8	75	53	46	13/16	7/16	1/2	65	45	100	75	25	65	30
30	38-1/4	30	10	1	1	2-1/4	38-3/4	32-7/8	3/8	36	28	1-1/4	1-3/8	101-1/2	70	58	15/16	1/2	1/2	55	45	80	70	25	55	30
36	46	36	10	1	1	2-1/4	46	39	3/8	42-3/4	32	1-1/2	1-5/8	137-1/2	99	97	15/16	1/2	1/2	55	45	80	70	25	55	30
42	53	42	12	1-3/16	1-1/8	2-1/2	53	45-1/4	3/8	49-1/2	36	1-1/2	1-5/8	182-1/2	127	150	1	9/16	1/2	55	40	80	60	15	55	30
48	59-1/2	48	12	1-3/16	1-1/8	2-1/2	59-1/2	51-1/4	3/8	56	44	1-1/2	1-5/8	211	164-1/2	163	1	9/16	1/2	55	40	80	60	15	55	30
54	66-1/4	54	12	1-3/16	1-1/8	2-1/2	66-1/4	57-1/4	3/8	62-3/4	44	1-3/4	2	265-1/2	185	226	1	9/16	1/2	55	40	80	60	15	55	30
60	73	60	12	1-3/16	1-1/8	2-1/2	73	63-1/4	3/8	69-1/4	52	1-3/4	2	309	221	262	1	9/16	1/2	55	40	80	60	15	55	30
72	88-1/2	72	12	1-3/16	1-1/8	2-1/2	88-1/2	75-1/4	3/8	82-1/2	60	1-3/4	2	385	303	321	1	9/16	1/2	45	40	70	60	15	45	30
78	93	78	12	1-3/16	1-1/8	2-1/2	93	81-1/4	3/8	88-3/4	60	2	2-1/4	550	390	368	1	9/16	1/2	45	40	70	60	15	45	30
84	99-1/4	84	12	1-3/16	1-1/8	2-1/2	99-1/4	87-1/2	3/8	95-1/2	64	2	2-1/4	700	450	438	1	9/16	1/2	45	40	70	60	15	45	30
90	106-1/2	90	12	1-3/16	1-1/8	2-1/2	106-1/2	93-1/4	3/8	102-1/4	68	2	2-1/4	750	481	560	1	9/16	1/2	45	40	70	60	15	45	30
96	113-1/4	96	12	1-3/16	1-1/8	2-1/2	113-1/4	99-3/8	3/8	108-1/2	68	2-1/4	2-1/2	800	514	620	1	9/16	1/2	45	40	70	60	15	45	30

NOTES:
 REFER TO DRAWINGS II-5200 FOR INSTALLATION INSTRUCTIONS.

CERTIFIED FOR:

JOB NAME: _____
 CUSTOMER : _____
 CUSTOMER P.O.: _____
 SALES ORDER: _____

**MODEL 2000 RUBBER
 EXPENSION JOINT SINGLE SPHERE**



THE VMC GROUP
 The Power of Together
 Bloomingdale, NJ 07403
 Houston, TX 77041

SCALE :
 NONE

SHEET:



DRAWING NO.: _____ REVISION