

# MOMENT LOADING FOR THE MSA-PSC ACTUATOR

(CALCULATED FROM THE TOP OF THE CART)

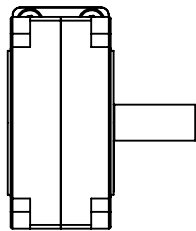

$M_x = 70 \text{ in-lbs, } 8 \text{ Nm.}$

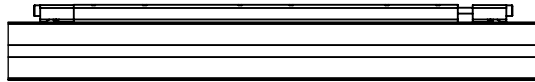

$M_y = 480 \text{ in-lbs, } 54 \text{ Nm.}$



$M_z = 900 \text{ in-lbs, } 101 \text{ Nm.}$



MACRON DYNAMICS INC