

REV.	DESCRIPTION	DATE	BY

PART NO.	MODEL NO.	AXIAL STATIC LOAD MAX LBS.	RADIAL STATIC LOAD MAX LBS.	SHORE A DUROMETER $\pm 5$	COLOR CODE DOT	MATERIAL
RB2-150EHT	RB2-150EHT	150	60	50	RED	BLUE EHT SILICONE
770006-4	RB2-300EHT	300	120	60	GREEN	RED EHT SILICONE

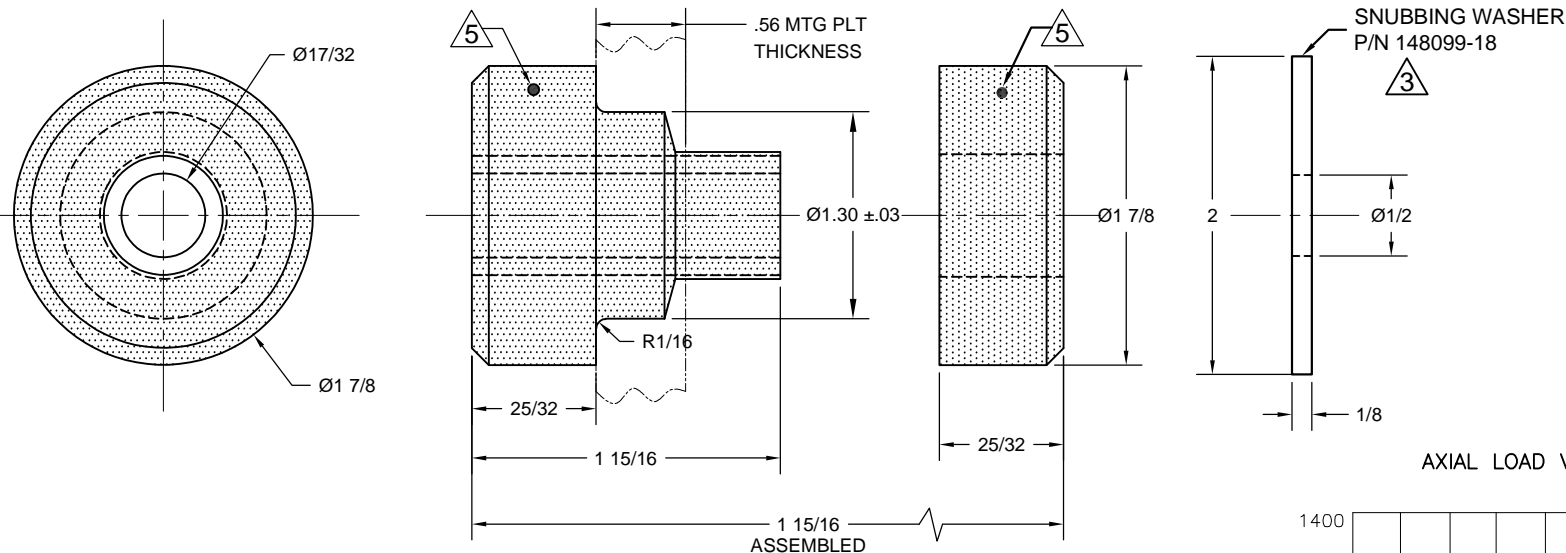

## NOTES:

1. ALL DIMENSIONS ARE IN INCHES. INTERPRET PER ANSI Y14
2. ALL DIMENSIONS ARE NOMINAL AND FOR REFERENCE ONLY.
3. SNUBBING WASHER IS OPTIONAL, ORDER SEPERATE ON PURCHASE ORDER.
- FINISH: YELLOW ZINC PLATED PER ASTM B633 TYPE II, CLASS SC 3 UNLESS OTHERWISE SPECIFIED.
4. COLOR-CODE "MARK" IS AN ACCEPTABLE ADDITION TO MODEL STAMPING.
5. STAMPING SURFACE LOCATION AS MARKED ON DRAWING.
6. 17/32" HOLE FOR 1/2" BOLT

AXIAL LOAD Vs. DEFLECTION

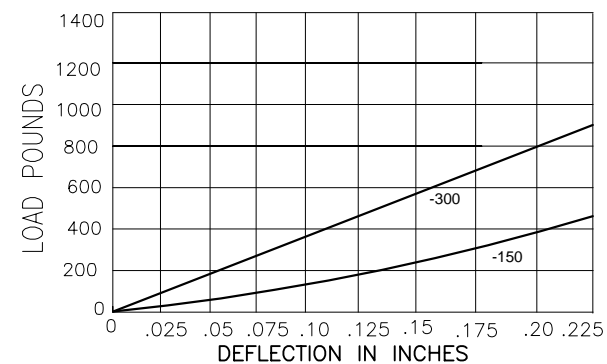

OTHER MATERIALS, COMPOUNDS, OR FINISHES WITH EQUAL OR SUPERIOR PROPERTIES MAY BE SUBSTITUTED AS THEY BECOME AVAILABLE.

## CERTIFIED FOR:

JOB NAME: \_\_\_\_\_

CUSTOMER : \_\_\_\_\_

CUSTOMER P.O.: \_\_\_\_\_

SALES ORDER: \_\_\_\_\_

MODEL RB2 150-300 LBS.  
EXTREME HIGH TEMPERATURE  
RING AND BUSHING  
ELASTOMERIC ISOLATOR



**VMC GROUP**  
THE POWER OF TOGETHER™  
Bloomingdale, NJ 07403  
Houston, TX 77041

SCALE:

NONE

SHEET:

1 OF 1

DRAWING NO.:

REVISION

Member  
**VISCMA**